

# PM2 Monitor Parts Replacement

## Tools Required:

Phillips head screwdriver

2 x 7/16" (11mm) spanners

1. Remove sensor cable from monitor.

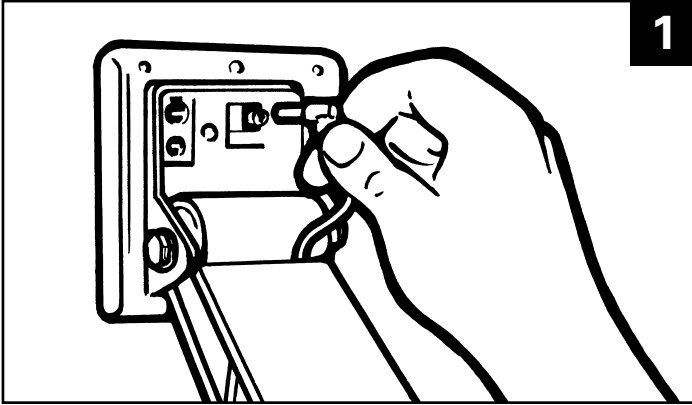

2. Remove monitor from arm using 2 x 7/16" (11mm) spanners.

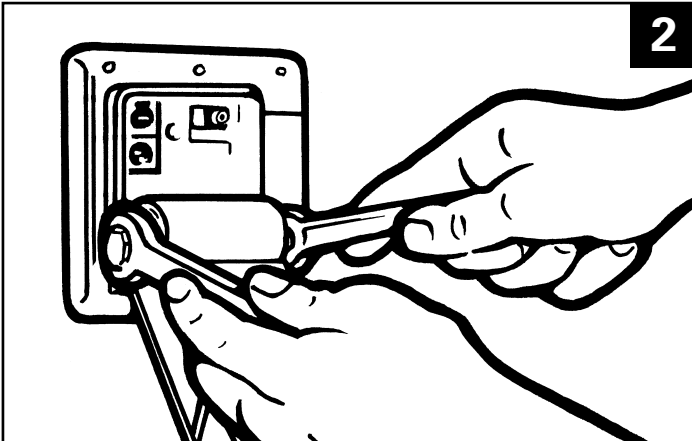

3. Remove Phillips head screws from rear cover.

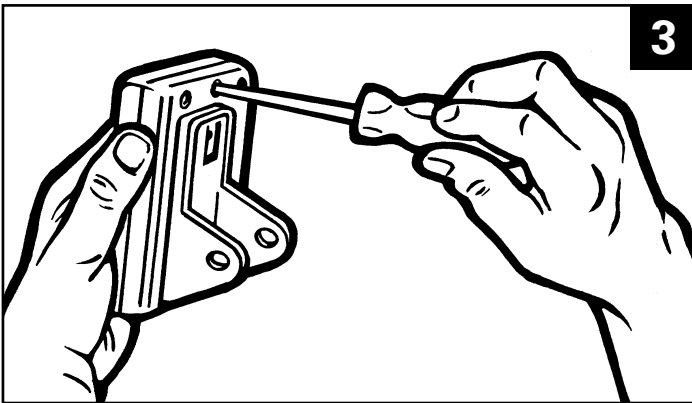

4. Remove Phillips head screws from circuit board.

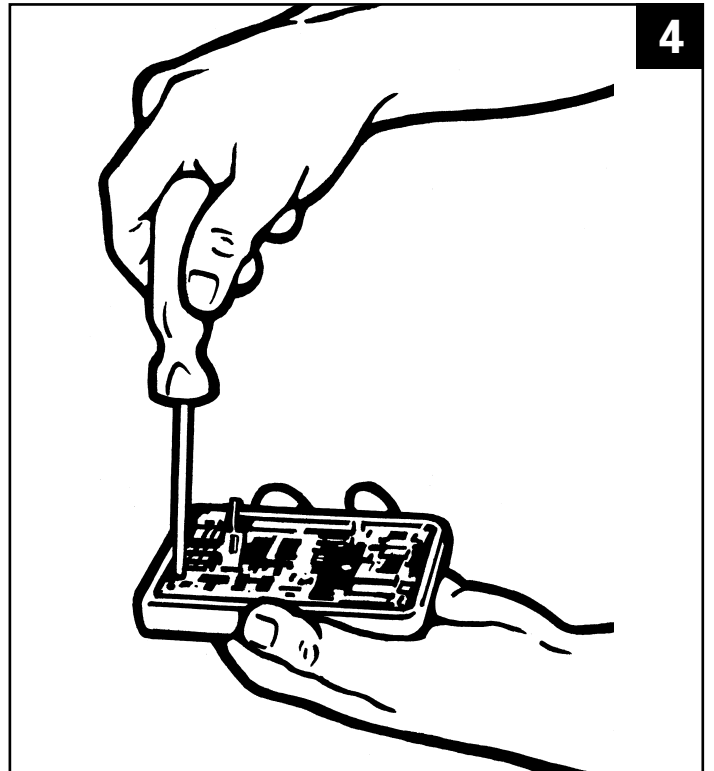

5. Remove and replace rubber key pad (if required). Ensure holes on corners of key pad are in line with locating pins.

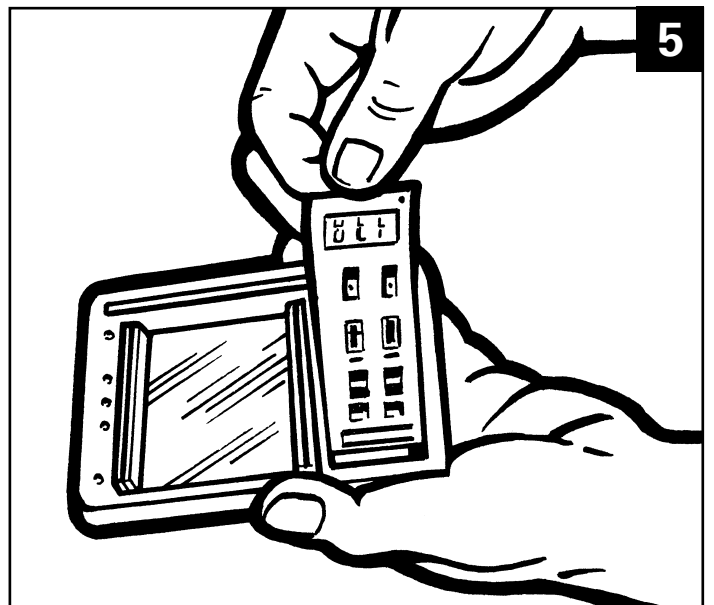

**Note:** the Indoor Rower is built to Imperial measurements, however you may have to use the closest Metric tool available in the UK (shown in brackets)